

DUAL PURGE, DUAL GUN MANIFOLD ASSEMBLY: SP66M20

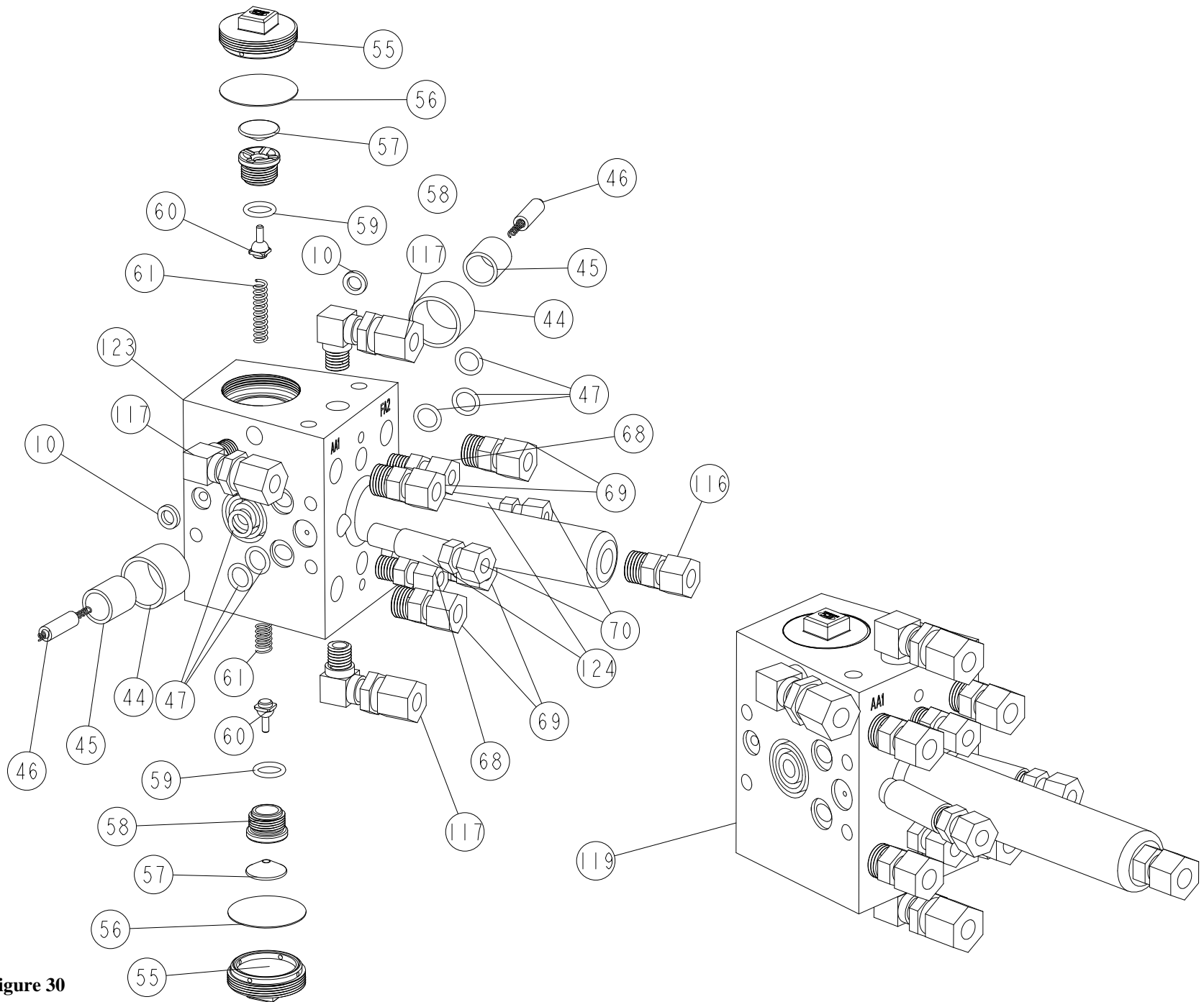

Figure 30

DESCRIPTION	ITEM #	FIG	EFC PART #	SAMES® PART #
WASHER, FLAT, TEKREZ® (CHEMICALLY RESISTANT)	10	30	252L60	82-0883-00
OUTER SLEEVE	44	30	600A40	449707
INNER SLEEVE	45	30	601A40	449706
RESISTOR ASS'Y	46	30	612A40	740532
O-RING, VITON®	47	30	8919VR	J2FTCF018
O-RING, TEKREZ® (CHEMICALLY RESISTANT)	47.1	30	8919CR	82-0410-03
VALVE COVER NUT, SQUARE	55	30	201M50M	72-0559-01
VALVE COVER NUT, 2 HOLE	55.1	30	201M50	449548
VALVE DIAPHRAGM	56	30	202M50	449549
VALVE DIAPHRAGM HOLDER	57	30	203M50	449546
SEAT, STAINLESS STEEL	58	30	211M50	742761
SEAT, COMPOSITE	58.1	30	30-1A22	N/A
O-RING, TEFLON®	59	30	1020TR	J3TTTCN007
NEEDLE VALVE, STAINLESS STEEL	60	30	210M50	740511
NEEDLE VALVE, COMPOSITE	60.1	30	210M50A	N/A
VALVE SPRING	61	30	213M50	742760
FITTING, NYLON	68	30	1806NYF	85-0059-30
FITTING, NYLON	69	30	1438NYF	85-0151-17
FITTING, NYLON	70	30	1836NYF	85-0151-07
FITTING, NYLON ELBOW	117	30	1814NYE	85-0153-56
MANIFOLD ASS'Y, DP, D GUN, RECIP	119	30	SP66M20	N/A
MANIFOLD BODY, DP, D GUN, RECIP	123	30	SP66M20A	N/A
EXTENSION TUBE	124	30	18XTB	N/A
FITTING, NYLON, MOD FOR 90KV CABLE	300	30	1412NYF-S	N/A
FITTING, NYLON, MOD FOR 60-1A13 CABLE (1/4" DIA) 100KV	301	30	1414NYF-M	N/A